

Alumaflex™

Rubber/Ceramic Linings

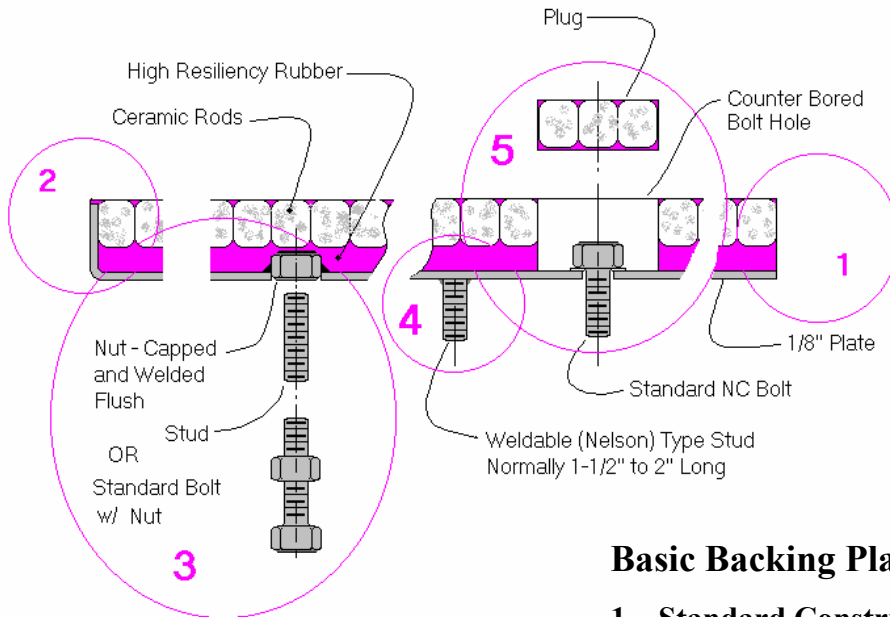

Basic Backing Plate Design

1 – Standard Construction

2 – Tray Style

Fastening Options:

3 – Threaded Hole on Liner – Capped Threaded Insert welded to the plate, and embedded into the liner body. A Stud, a short bolt or a Standard Bolt with a nut threaded part way can be used to fasten the liner in place.

This system provides a strong anchoring method, and ensures an uninterrupted wear surface.

4 – Welded Stud - This is a satisfactory option, however, it introduces other problem; Invariably some studs get bent or threads get damaged during handling. Also in some applications, metal fatigue may develop on the plate itself around the weld. Vibrating screens liners are good examples

5 – Counter Bored Bolt Hole and plug - Any hole on any wear surface, potentially weakens it. This method should only be used when access through the other side of the mounting structure is impossible.

Distributed by:

REMA TECH

INDUSTRIES